

LIGHTBOX DOUBLE 100 DIBOND

Standing and hanging textile ledframe

NF-041005 Silver

NF-211005 Black

NF-561005 White

Colors:



Silver



Black



White

Available in every color on request.

Application: Freestanding and suspended from ceiling

Width: 100mm

Length: 6150mm

Weight: 1,258 kilo/meter

Possibilities: By LED on stabilizer is any size possible

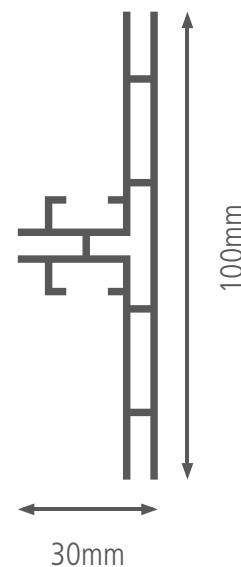

Including **PHILIPS**
patents license

This double-sided lightbox with smooth finish is suitable for freestanding and suspended use. The LEDs on dibond ensure a high quality light distribution. Unique is the choice of two light intensities and the ability to dim the light. This firm lightbox is perfect to use in a retail window display and as stunning partition wall in the office.

- Illumination by led's on dibond
- Equal light distribution for perfect illumination
- Ideal for retail window displays or unique partition wall

Optional

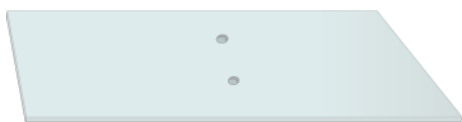

FK-0110

Baseplate for standing. Material: Steel.

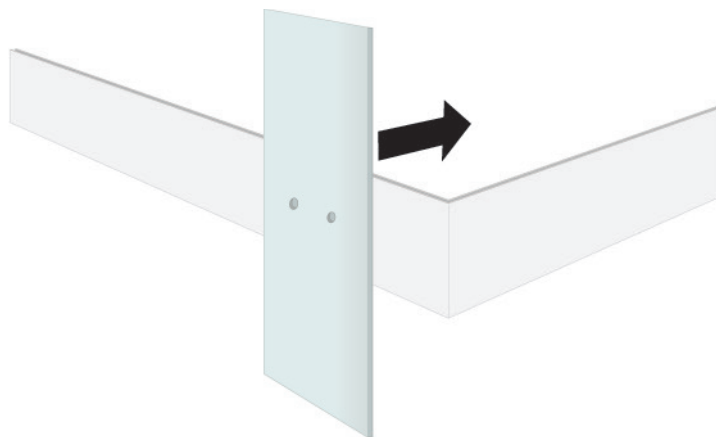

Optional



FK-0306

Suspended from ceiling.

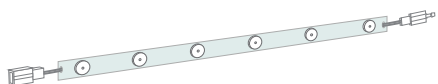
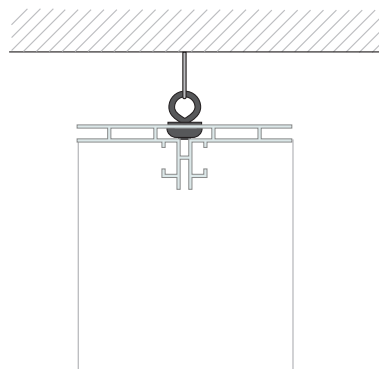

BACK LIGHT DIBOND

5000-7000k White.

1.2W 24V. 12, 6, 3 or 2 lenses.

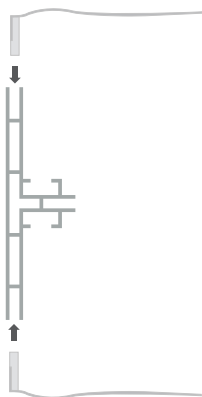
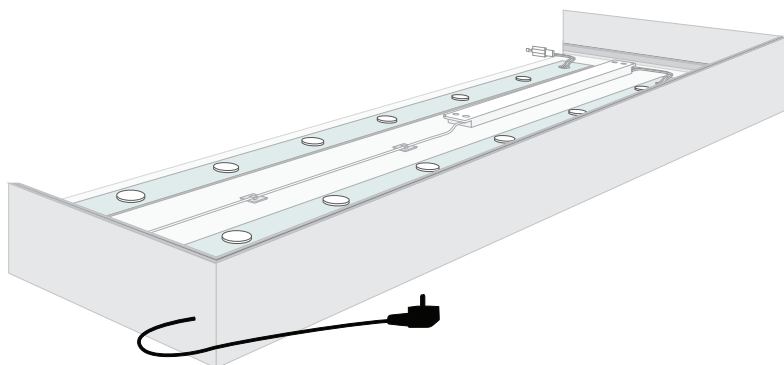

Place the textile print in the frame. Start with the corners and press the silicone strip in the channel.

