

PANEL HANGING 18

Single-sided frame

NF-04183 Silver

Colors:



Silver

Available in every color on request.

Application: Wall mount
Width: 18mm
Length: 6150mm
Weight: 0,357 kilo/meter

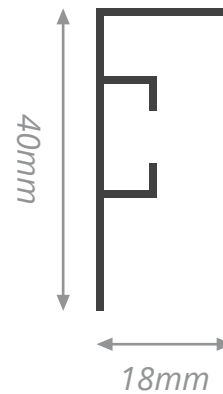

This aluminum profile is a frameless solution to let your print stand out. The profile is attached to the back of your sheet material, before mounting it to the wall. It lets the print float, which makes it perfect for a presentation of artwork in office, showroom or (art) galleries.

- Suitable for canvas and plate material
- Easy installation
- Economic solution

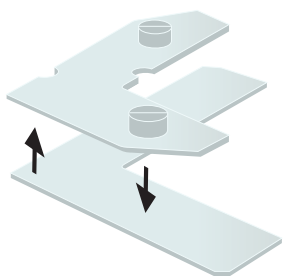

FK-0210

Each frame is delivered with 4 locksets.

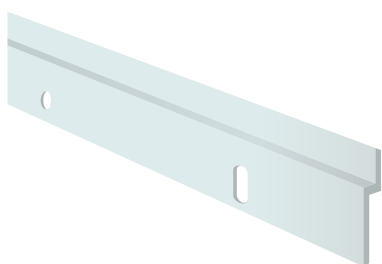

FK-8020 / FK-8050 / FK-8120

The mounting of a frame can be done using wallmounts.

Optional

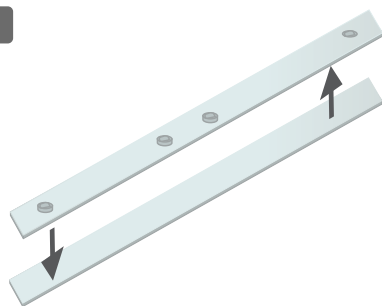

FK-0510

If the length of the frame is longer than 4 meters, an extension set is included



Sheet material

Place the sheet material in the frame.

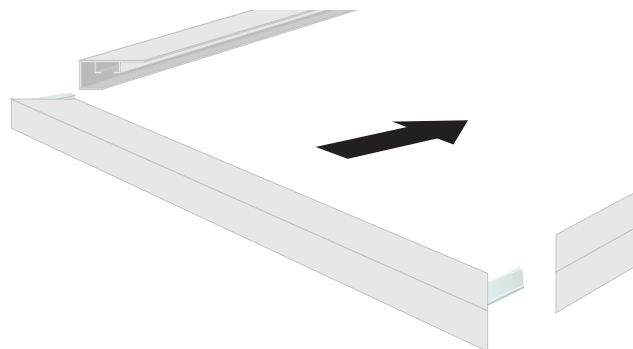

When connecting the frame, first place the lockset FK-0210 without the punchholes, then the one with punchholes.

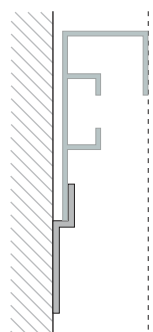

Wall mounting

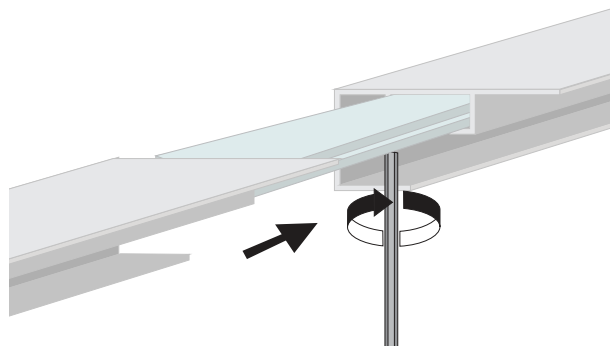

These extension sets can be placed in the channels where the frame is cut in half.

