

LIGHTBOX DOUBLE 200

Standing and hanging textile ledframe

NF-042000 Silver

NF-212000 Black

NF-562000 White

Colors:



Silver



Black



White

Available in every color on request.

Application: Freestanding and suspended from ceiling

Width: 200mm

Length: 6150mm

Weight: 3,215 kilo/meter

Option: Sound absorbing felt in combination without LED's

Possibilities: By LED on stabilizer is any size possible



Including **PHILIPS**
patents license

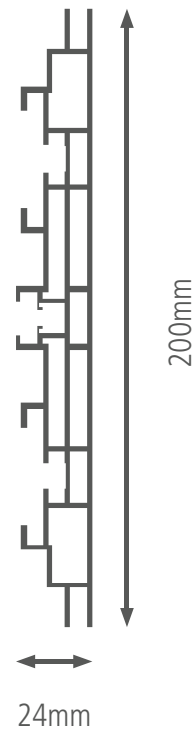
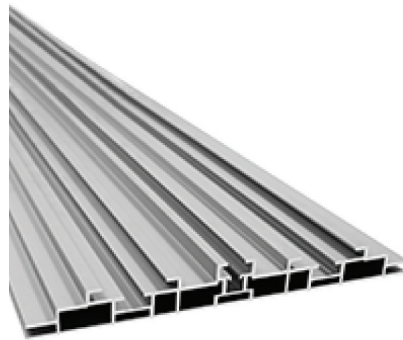

This aluminum profile is specifically designed for illuminating large format double-sided textile printing. With a smart design with multi-channel this profile is suitable for both standing and hanging. Combined with our High PowerLED modules perfect double light wall arises.

- Suitable for textile printing silicone strip
- Suitable for High PowerLED module
- Stabilizers for optimum reinforcement
- Various accessories for standing or hanging
- Disassembled transport possible
- Any size possible

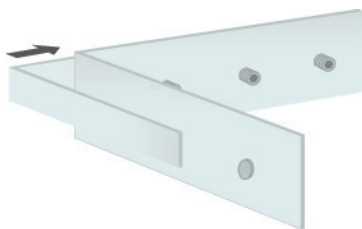

FK-0230

Each frame is delivered with 4 locksets D200.

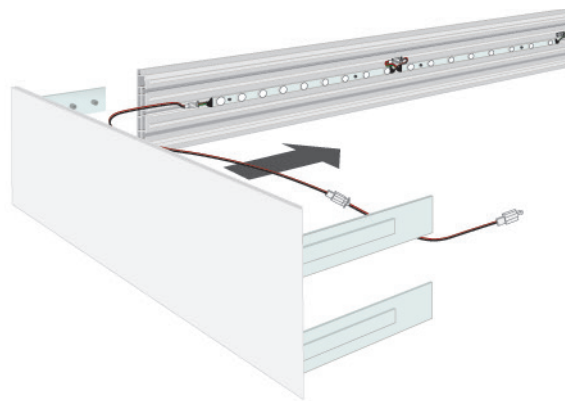

Optional

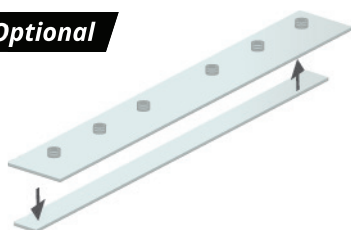

FK-0530

If the length of the frame is longer than 4 meters, an extension set (FK- 0530) is included.

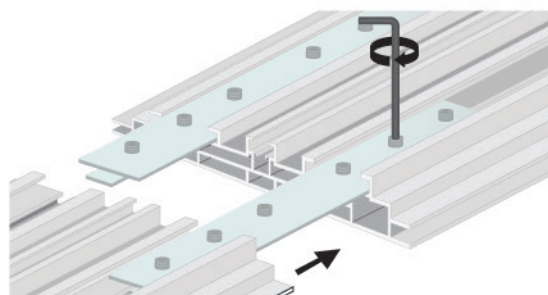

These extension sets can be placed in the channels where the frame is cut in half.

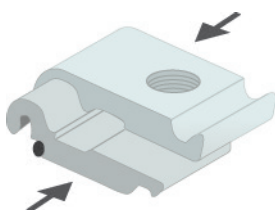

FK-0220

When connecting the stabilizer, first place the lockset in the channel.

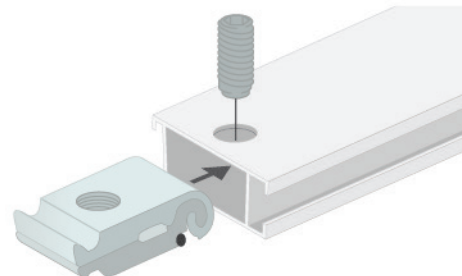

Then put the stabilizer (NF- 04438) on the lockset, now tighten the screw with the delivered allen key.

Optional



LED POWER SUPPLY

200-240V



Sec.: 24VDC, Max 2.5A
tc: 80° ta:45°C

Optional

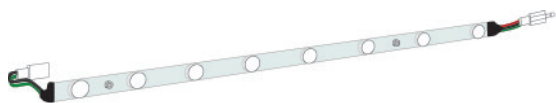

HEAVY POWERLED

47cm x 25mm x 15mm. 5000-7000k White.
9x lenses 2.8W 24V.



Optional

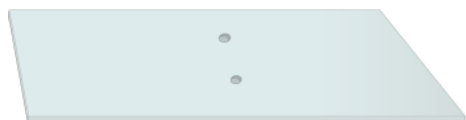

FK-0110

Footplate for standing. Material: Steel.

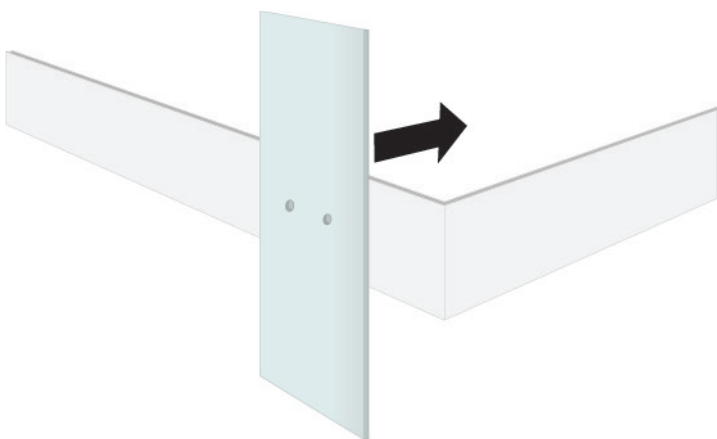

Optional



FK-0306

Suspended from ceiling.

