

SLIM 25

Single-sided frame

NF-04250 Silver
NF-21250 Black
NF-56250 White
NF-04250PH Punchholes Silver
NF-21250PH Punchholes Black
NF-56250PH Punchholes White

Colors:



Silver Black White

Available in every color on request.

Application: Wall mount
Hanging
Width: 25mm
Length: 6150mm
Weight: 0,476 kilo/meter
Option: Sound absorbing

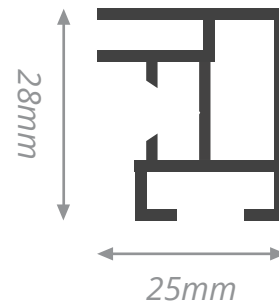

This single-sided profile is a very popular and firm aluminium frame. This frame can be mounted to the wall or suspended from the ceiling and is available in any colour. Widely used in home decoration or retail and office interiors. This firm profile is typically used in home decoration and the interior of retail spaces and offices. This single-sided frame can be mount to the wall or ceiling.

- Firm textile frame
- Three options of mounting the frame
- Use stabilisers above 2 meters

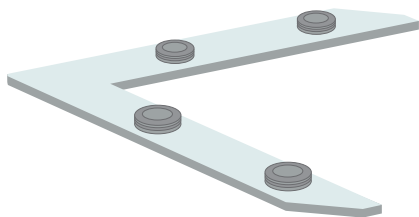

FK-0214

Each frame is delivered with 4 locksets.

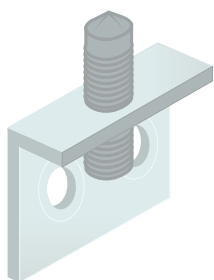

FK-0400 / FK-0410

The mounting of a frame can be done using wallmounts or by drilling through the frame.



FK-0420 / FK-0422

With our ceiling mounts you can quickly and easily hang up the frame.

Optional

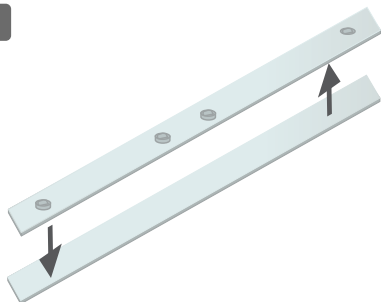

FK-0510

If the length of the frame is longer than 4 meters, an extension set is included

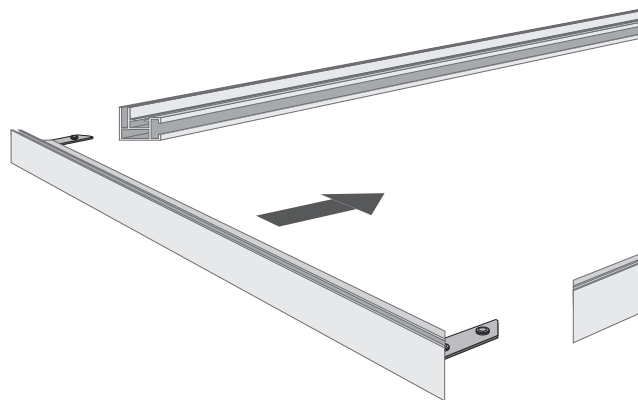

When connecting the frame place the lockset FK-0214

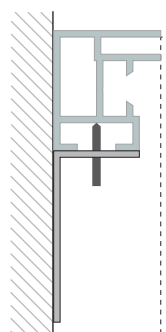

Wall mounting

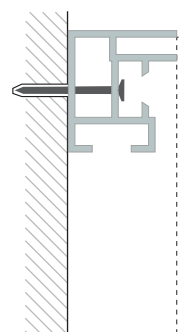

Drilling

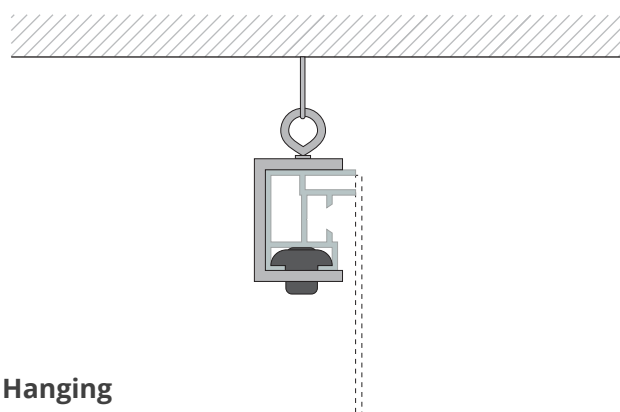

Hanging

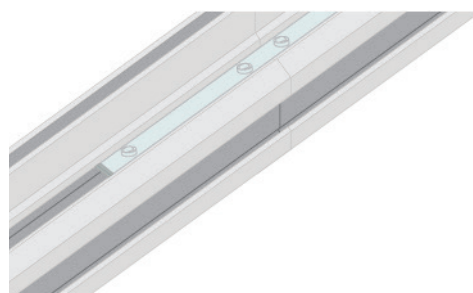

These extension sets can be placed in the channels where the frame is cut in half.

Optional

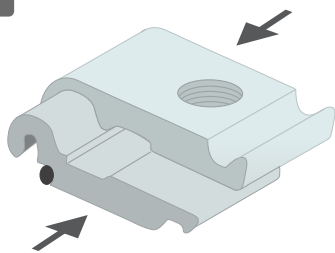

FK-0220

When connecting the stabilizer, first place the lockset in the channel.

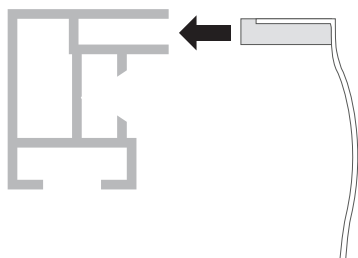

Textile print

Place the textile print in the frame. Start with the corners and press the silicone strip in the channel and close the frame.

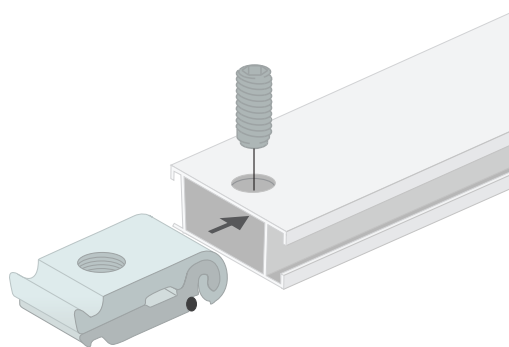

Then put the stabilizer (NF- 04438) on the lockset, now tighten the screw with the delivered allen key.

