

CABINET 30

Built-in frame

NF-04340 Silver

NF-21340 Black

Colors:



Silver

Black

Available in every color on request.



Application: Built-in

Width: 30mm

Length: 6150mm

Weight: 0,286 kilo/meter

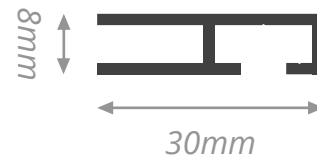

This single-sided textile frame is intended to be built into a niche, frame or cabinet to create custom made display solutions. This aluminium frame is used to finish off a niche, frame or cabinet. An ideal built-in solution.

- Low-cost textile frame
- Perfect to finish off a niche or cabinet
- Built-in solution

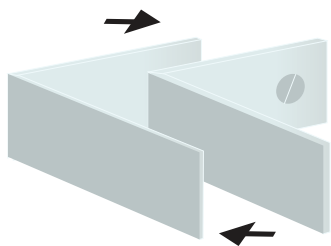

FK-0260

Each frame is delivered with 4 locksets.

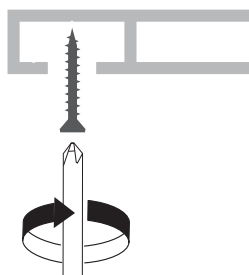

Built-in

The mounting of a frame can be done by drilling.

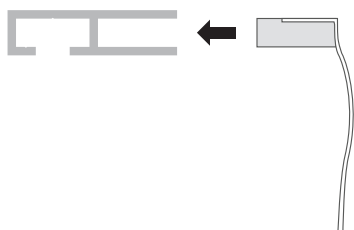

Textile print

Place the textile print in the frame. Start with the corners and press the silicone strip in the channel and close the frame.

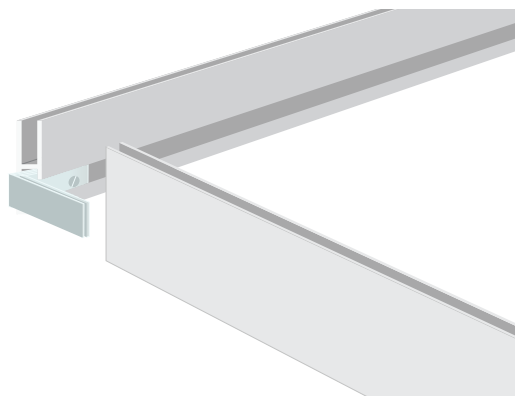

When connecting the frame, first place the lockset FK-0260 without the punchholes, then the one with punchholes.

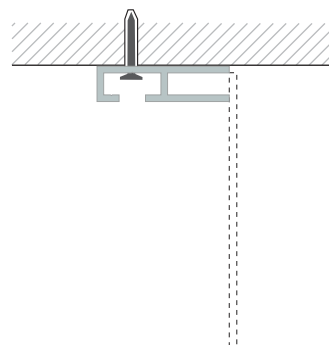

Drilling

