

## DECOR 27 XL 45

Single-sided frame

NF-56450-XL White

### Colors:



White

Available in every color on request.

<b>Application:</b>	Wall mount
<b>Width:</b>	27mm
<b>Length:</b>	6150mm
<b>Weight:</b>	0,892 kilo/meter
<b>Option:</b>	Sound absorbing

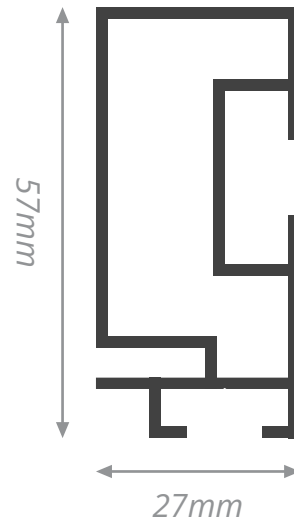

This single-sided and most strongest profile for the wall. Available in all colors. This aluminum frame is normally used in retail and office interiors or at public areas. The thick aluminum frame creates a modern eye-catcher.

- Strong textile frame
- Do through the thick frame a real eyecatcher
- Use stabilisers above 2 meters

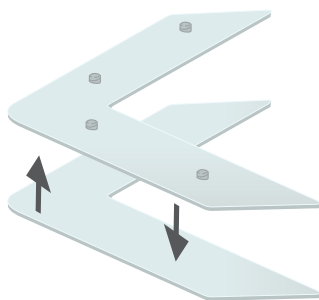

### FK-0200

Each frame is delivered with 4 locksets.

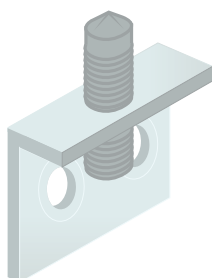

### FK-0400 / FK-0410

The mounting of a frame can be done using wallmounts.

*Optional*

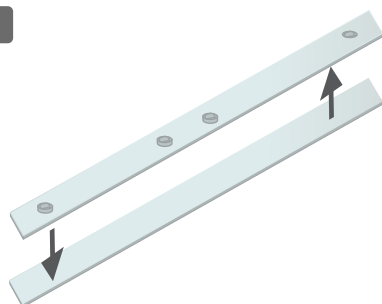

### FK-0500

If the length of the frame is longer than 4 meters, an extension set is included

*Optional*

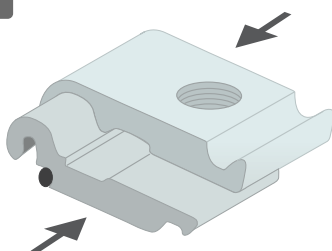

### FK-0220

When connecting the stabilizer, first place the lockset in the channel.

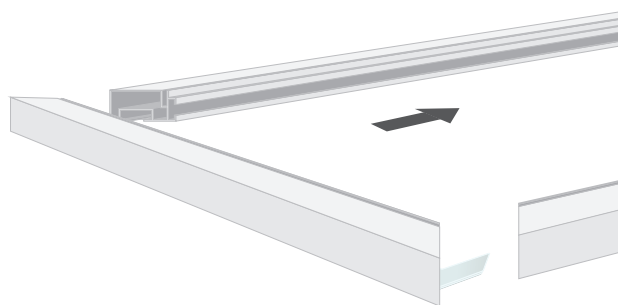

When connecting the frame, first place the lockset FK-0200 without the punchholes, then the one with punchholes.

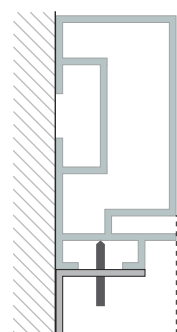

### Wall mounting

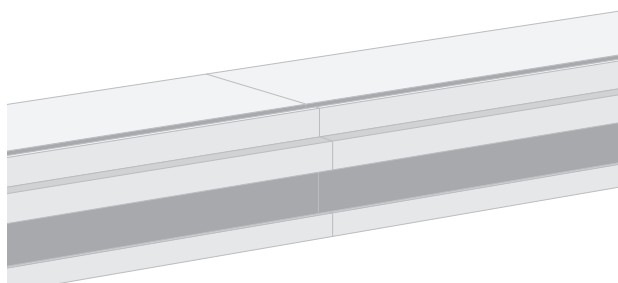

These extension sets can be placed in the channels where the frame is cut in half.

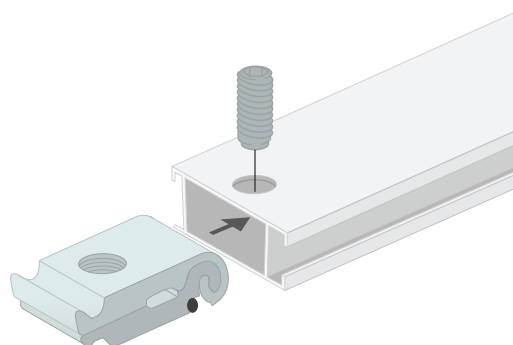

Then put the stabilizer (NF-04438) on the lockset, now tighten the screw with the delivered allen key.

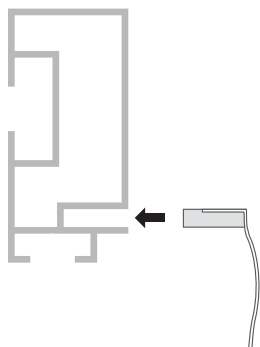

### Textile print

Place the textile print in the frame. Start with the corners and press the silicone strip in the channel and close the frame.

